



Clifford Street Intersection Finishing Works

From Monday 4 November 2013, the intersection of Clifford Street and Surfers Paradise Boulevard will be closed to all west bound traffic to facilitate finishing works.

Finishing works in the intersection include the construction of asphalt, kerbing and guttering. These works are expected to take two weeks to complete.

Traffic changes:

- The intersection of Clifford Street and Surfers Paradise Boulevard will be closed to all westbound traffic (see map).
- Construction will be undertaken in phases to maintain east bound traffic at all times.
- Surfers Paradise Boulevard will be closed to all southbound traffic from Laycock Street to Clifford Street during phase one only (see construction notice overleaf).
- Local access for businesses and residents in Clifford Street east will be maintained from the Esplanade.
- Pedestrian access routes will be maintained around the construction area. Temporary footpath closures near the active work area will occur and alternative routes will be signed.
- During construction, please drive to the conditions at all times as points of access, temporary lane closures and changes to traffic flow will occur.

What to expect:

- Installation of safety barriers and fencing to contain the construction area.
- Heavy machinery, such vibration rollers to facilitate construction activities.
- Construction noise, dust and vibration at times. Every effort will be made to minimise these impacts.
- The majority of construction work will be carried out between 6:30am and 6:30pm, Monday to Saturday.
- Timing of this work is subject to weather conditions and construction constraints.

Night works:

- Night works will be required as part of these works to minimise the impact on businesses, pedestrians and traffic. Affected businesses and residents will be notified in advance of night works.
- During night works vehicles will use “quacker” (quieter) style reversing alarms to reduce noise.
- Light towers will be placed to limit glare to nearby residences.

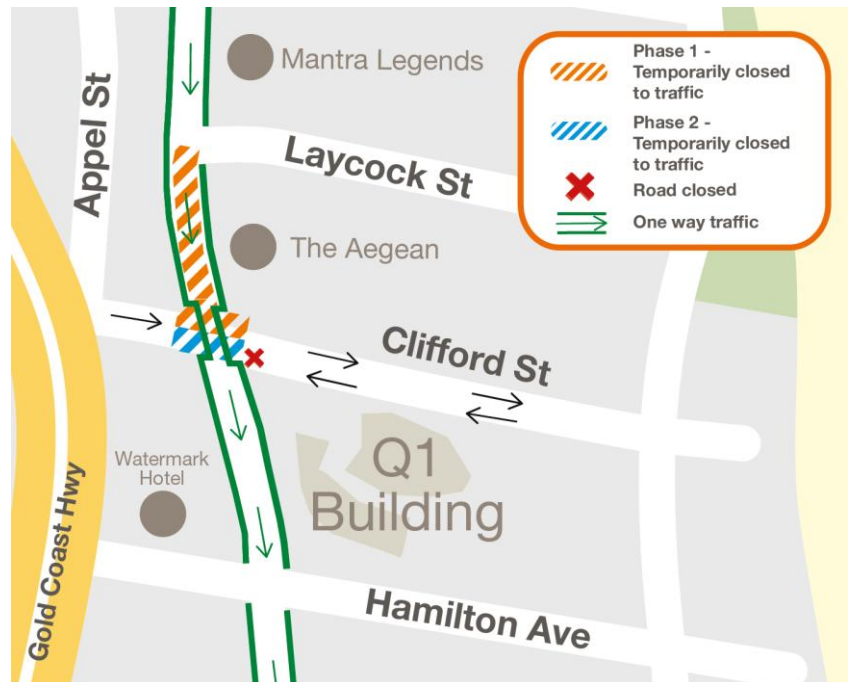

Keep up-to-date with the progress of Queensland's first contemporary light rail at www.goldlineq.com.au or call the project on 1800 967 377*.

*Free call within Australia. Call charges may apply from mobile phones and payphones.



Australian Government

CITY OF
GOLDCOAST



Queensland Government

CN (CAP00039)O2