

Weekly Construction Update #77

Week commencing 30 September 2013

Overhead wires are live and trams will be testing in Southport

Look up and see the danger [overhead wires for the light rail are now live in Southport](#) from Scarborough Street to Parklands Drive.

[Trams are now testing in Southport](#). Remember tracks are for trams, only cross at designated crossings and never queue on the tracks. Obey all signs, signals and road rules and look and listen for trams.

Parklands

Asphalting is complete and footpath and kerbing works continue. Overhead wires will be live from the Depot to the underground Gold Coast University Hospital Station.

Depot

The maintenance building fit out is complete and the first two trams are now moving around within the stabling yard area.

Smith Street Bridge

Rail across the bridge is laid and overhead wires are live to prepare for trams to move in this area.

Southport

Baratta Street

Landscape and rehabilitation work continue at the bio-retention basin behind the Depot. This will involve truck movements in Baratta Street.

Queen Street

Between Wardoo and Nerang Streets

Work will continue to install signs and CCTV footings. There will also be night time lane closures for line marking.

Nerang Street

Between Davenport and Scarborough Streets

Footpath paving work will occur with the existing footpath tiles being jack-hammered and removed. Pedestrian and business access will be maintained, please obey signs and traffic controllers. Station landscaping work will also continue.

Nerang Street Mall

Work reconfiguring the median and kerbs will occur at the intersection of the Nerang Street Mall and Gold Coast Highway.

Scarborough Street

Between Nerang Street and Short Street

Kerb, median and landscape works continue.

Between Lawson Street and Park Lane

Kerb and footpath works continue.

Between Nerang Street and Queen Street

Track finishing works continue.

Scarborough Street and Nerang Street Mall traffic changes

From Thursday 10 October 2013, [Scarborough Street will become one-way southbound between Nerang Street and Queen Street](#) as footpath, landscape and finishing works are undertaken progressively in sections for ten weeks.

Northbound traffic will detour will be via Queen, Garden and Davenport Streets to access Scarborough Street.

Nerang Street Mall will become one-way westbound to facilitate bus movements through the shared zone and **the northbound bus stop on the western side of Scarborough Street near Southport RSL will also be temporarily closed**

Access to driveways and businesses will be maintained.



Keep up-to-date with the progress of Queensland's first light rail and to sign up for updates visit www.goldlink.com.au or call the project hotline on 1800 967 377*

*Free call within Australia. Call charges may apply from mobile phones and payphones.



Australian Government

CITY OF
GOLDCOAST



Queensland Government

Weekly Construction Update #77

Week commencing 30 September 2013

Queen Street

Near the Croquet Club

Broadwater Parklands Station construction and drainage, services installation and track form construction will continue opposite the Shores. Night works will be required throughout the week.

Barney Street

Track preparation and electrical services installation continues.

Nerang River

Shared cycle and pedestrian bridge

Piling work on the southern side of the bridge continues.

Light rail bridge

Concreting of the bridge decks continues.

Nerang River Barge movements

The barge Leonora is on the eastern side of the traffic bridge near the Proud Park boat ramp for piling works. Mariners are advised to watch for anchor cables, obey speed limits, buoys and signs. Details are available on the [Maritime Safety Queensland website](http://www.maritime.safety.qld.gov.au).

Paradise Waters

Gold Coast Highway

Station works continue at Tedder Avenue.

Macintosh Island South Bridge

Construction of bridge decks continues.

ARMOR ALL Gold Coast 600

The ARMOR ALL Gold Coast 600 will take place on the streets of Surfers Paradise between 25 and 27 October.

V8 Supercars have begun constructing the precinct in Main Beach and Surfers Paradise. There will be a number of short term road closures over the construction period, with the majority being early in the morning or late at night to minimise public disturbance. There will also be some longer term road closures and changes to traffic direction. Full details of traffic changes will be available closer to the event.

Surfers Paradise

Major construction of track form, underground services and station work continues in Surfers Paradise.

Gold Coast Highway Traffic Changes

A southbound lane has been reopened along Ferny Avenue (Gold Coast Highway). Surfers Paradise Boulevard is closed from Ferny Avenue to Main Beach Parade with local access only via Main Beach Parade.

Gold Coast Highway Night Works

Night works in the area will continue from Sunday 29 September to Friday 18 October 2013. Night works next week will include temporary lane closures on the Gold Coast Highway.

Ocean Avenue to View Avenue

Underground service and track form preparation continues. Night works will occur at Ocean Avenue throughout the week from 6:30pm to 6:30am.

The intersections of Ocean Avenue and Palm Avenue are closed to east-west traffic for track form construction. Ocean Avenue is two-way from the Gold Coast Highway for the duration of the closure and detours will be in place to access Ocean Avenue east and Surfers Paradise Boulevard via the Esplanade. Local access to Palm Avenue is available via the Gold Coast Highway. Night works will be required as part of these works.

Elkhorn Avenue to Cavill Avenue

During works at the Cavill Avenue intersection, traffic has been diverted through the light rail station area. Fencing has been installed to facilitate drainage and station works on the western side of the station.

Periodic footpath, landscaping and underground services works continue along Surfers Paradise Boulevard. Construction will occur from 6:30am to 6:30pm.



Weekly Construction Update #77

Week commencing 30 September 2013

Surfers Paradise Boulevard Closures

Surfers Paradise Boulevard between [Beach Road and Clifford Street](#) is closed. Access to Appel and Alison Streets is maintained from Trickett Street. Hanlan Street is closed to all east and westbound traffic. Access into Beach Road is maintained. Alternative routes and redirections are signed.

Cavill Avenue intersection

Works will occur on the eastern side of the Cavill Avenue intersection throughout the week. Access will be maintained for vehicles and pedestrians. Night works will occur from 6:30pm to 6:30am at Cavill Avenue intersection, adjacent to the Hilton Hotel with temporary footpath closures. Traffic management will be in place to assist.

Cavill Avenue to Beach Road

Night works to install underground services will continue from 6:30pm to 6:30am, Monday to Friday. Points of access may change and temporary lane changes will occur. Islander access is maintained.

Beach Road to Clifford Street

Track form construction, underground services installations and asphaltting works will occur. Some night works may be required.

Clifford Street Intersection

From Saturday 28 September the intersection of Clifford Street and Surfers Paradise Boulevard will be closed to west bound traffic to complete track form construction.

Westbound traffic from the Esplanade will be detoured to Surfers Paradise Boulevard, to return to the Gold Coast Highway at the Remembrance Drive intersection. Please drive to the conditions.

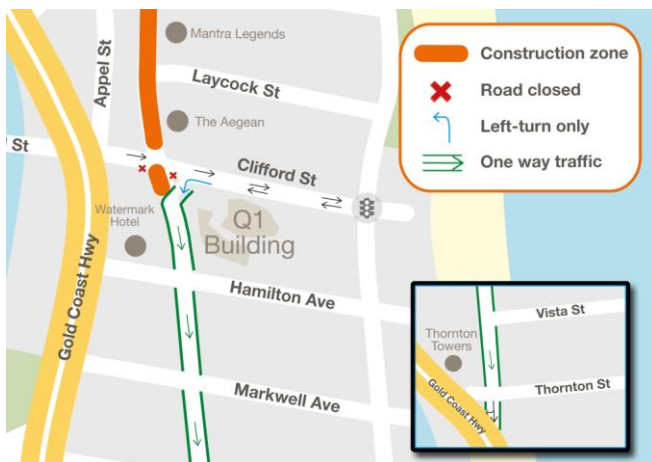

To unsubscribe from weekly updates please email [STOP to goldcoastlightrail@macdow.com.au](mailto:STOP@goldcoastlightrail@macdow.com.au)

Clifford Street to Thornton Street

Finishing works for underground services, signals, footpaths, landscaping and station works continues.

Markwell Avenue to Enderley Avenue

Footpath and pavement works start on the eastern side of Markwell Avenue to Enderley Avenue. Pedestrian access along the eastern footpath remains closed.

Vista Street Intersection

Vista Street intersection remains closed to all westbound traffic for finishing works including asphalt, footpaths, kerbing and landscaping. Local access is maintained via Northcliffe Terrace.

Periodic night works for traffic signals work continues at intersections on Surfers Paradise Boulevard between Clifford Street and Thornton Street between 6.30pm and 6.30am. Access will be maintained.

Broadbeach

Gold Coast Highway

Aubrey Street to Second Avenue

Finishing works continue from Aubrey Street to Second Avenue with lane closures at off peak times.

Florida Gardens Station

Foundation and station structure works continue. Lane closures will occur at off peak times.

Queensland Avenue

Night works to install pedestrian crossing traffic signals will begin during night works. Periodic lane closures will occur. Please drive to the conditions.

Main Place

Storm water drainage and kerb works continue at Main Place.

Victoria Avenue to Elizabeth Avenue

Rail delivery and track form construction will continue. Periodic lane closures will occur.

Margaret Avenue

Energex and traffic signal night works will continue at the intersection. Lane closures of the highway and pedestrian detours will occur.

Timing of these works is subject to weather conditions and construction constraints.

Keep up-to-date with the progress of Queensland's first light rail and to sign up for updates visit www.goldlineq.com.au or call the project hotline on 1800 967 377*

*Free call within Australia. Call charges may apply from mobile phones and payphones.



Australian Government

CITY OF
GOLDCOAST.



Queensland Government