

Parklands Drive and Alumni Drive intersection works

From 6:30pm Friday 1 February to 5:00am Monday 4 February 2013, the intersection of Parklands Drive and Alumni Place, Southport, will be partially closed.

Construction crews will work around the clock to install stormwater drainage and prepare the intersection for tracklaying during the quieter weekend traffic period.

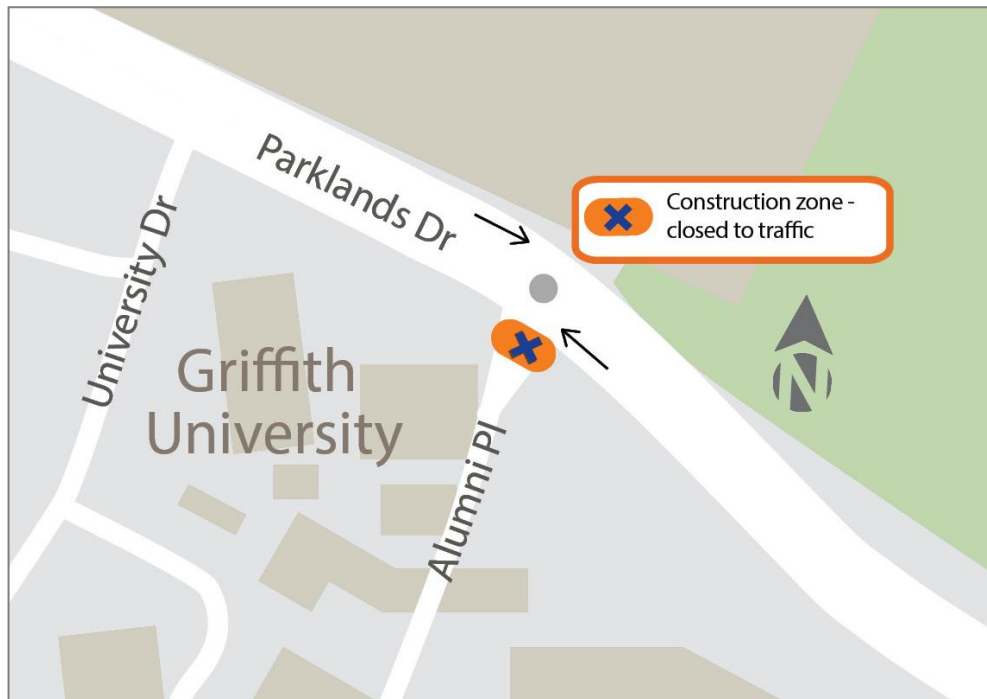

Traffic changes:

- Partial closure of the Parklands Drive and Alumni Drive intersection.
- There will be no access to Alumni Drive from Parklands Drive (see map).
- Through traffic will be maintained along Parklands Drive. Traffic control will be in place between University Drive and Engineering Drive.
- Vehicle access to Griffith University from Parklands Drive will be via University Drive and Engineering Drive.
- Pedestrian access routes will be maintained around the construction area.

What to expect:

- Construction crews will work from 6:30pm Friday 1 February to 5:00am Monday 4 February to ensure the intersection is re-opened to motorists by 6:00am.
- Construction will include excavation and installation of underground services.
- Heavy machinery, such as excavation and crane movements to facilitate construction activities.
- Construction noise, dust and vibration at times. Every effort will be made to minimise these
- During night works vehicles will use “quacker” (quieter) style reversing alarms to reduce noise.
- Light towers will be placed to limit glare.

Timing of this work is subject to weather conditions and construction constraints.

We apologise for any inconvenience and thank you for your patience during construction.

