



## Smith Street Bridge girders

From Sunday 9 December 2012 delivery and erection of bridge spans (girders) will commence for the Smith Street Bridge at Parklands Drive and across the Smith Street Motorway.

Sections of Parklands Drive and the Smith Street Motorway will be closed to traffic from 7:00pm to 5:00am during installation of four bridge spans.

### Traffic changes:

Changed conditions will occur in two phases:

Phase 1 – Up to four nights for erection of two bridge spans at Parklands Drive.

Phase 2 – Up to four nights for erection of two bridge spans across the Smith Street Motorway.

### Phase 1: Parklands Drive (see Map 1)

- Parklands Drive will be closed at the Smith Street Motorway intersection. Access to Parklands Drive will be via Olsen Avenue.
- The eastbound lane of the Smith Street Motorway will be closed between Olsen Avenue and Wardoo Street. Detours will be available via Olsen Avenue and Wardoo Street.
- Westbound traffic on the Smith Street Motorway will be maintained.

### Phase 2: Smith Street Motorway (see Map 2)

- On completion of Phase 1, Parklands Drive will be closed at Smith Street Motorway intersection. Access to Parklands Drive will be available via Olsen Avenue.
- Both directions of the Smith Street Motorway will be closed to traffic between Olsen Avenue and Wardoo Street. Detours for east and westbound traffic will be available via Olsen Avenue and Wardoo Street.

### What to expect:

- Work will occur between 7:00pm and 5:00am Sunday to Thursday.
- Heavy machinery and crane movements to facilitate construction activities.
- Construction noise, dust and vibration at times. Every effort will be made to minimise these impacts.
- Temporary footpath closures near the active work area will occur and alternative routes will be signed.
- During night works vehicles will use “quacker” (quieter) style reversing alarms to reduce noise.
- Speed limits will be reduced around work areas.
- Timing of this work is subject to weather conditions and construction constraints.

We apologise for any inconvenience and thank you for your patience during construction.



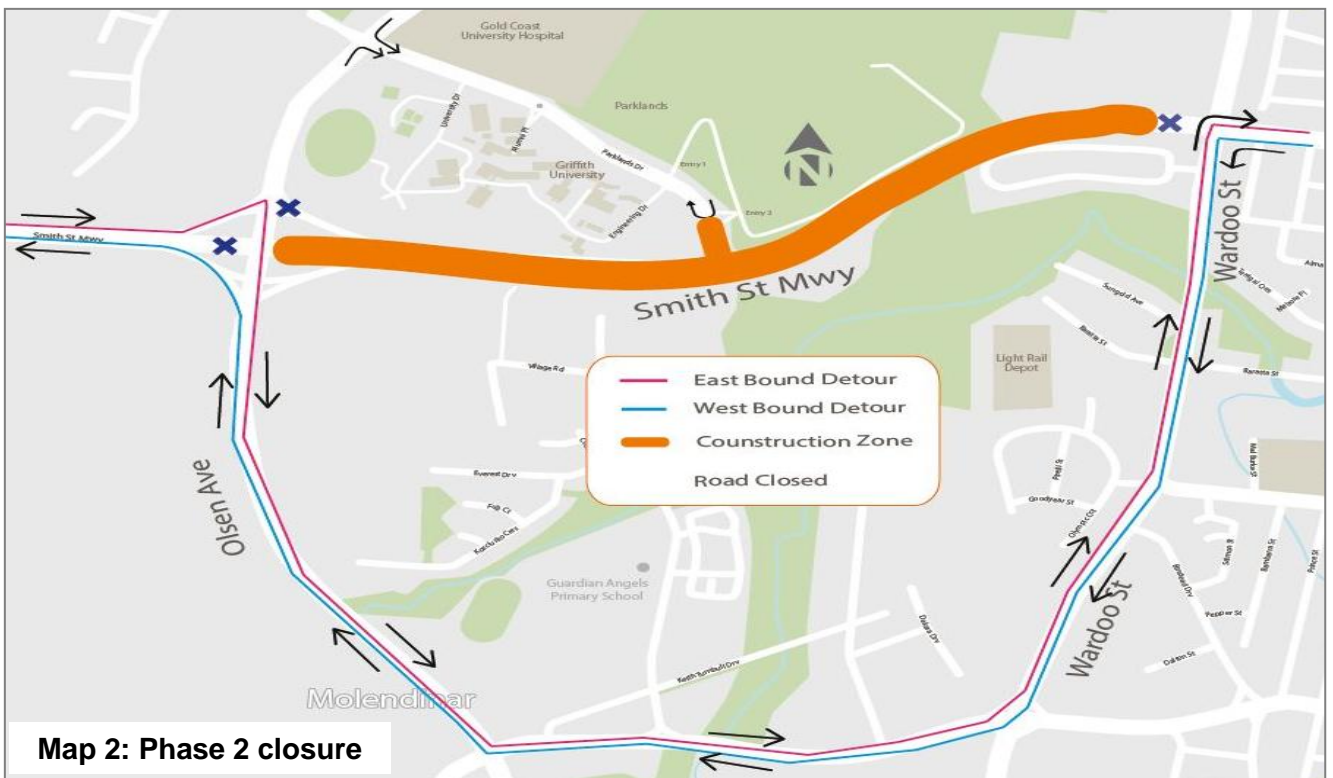
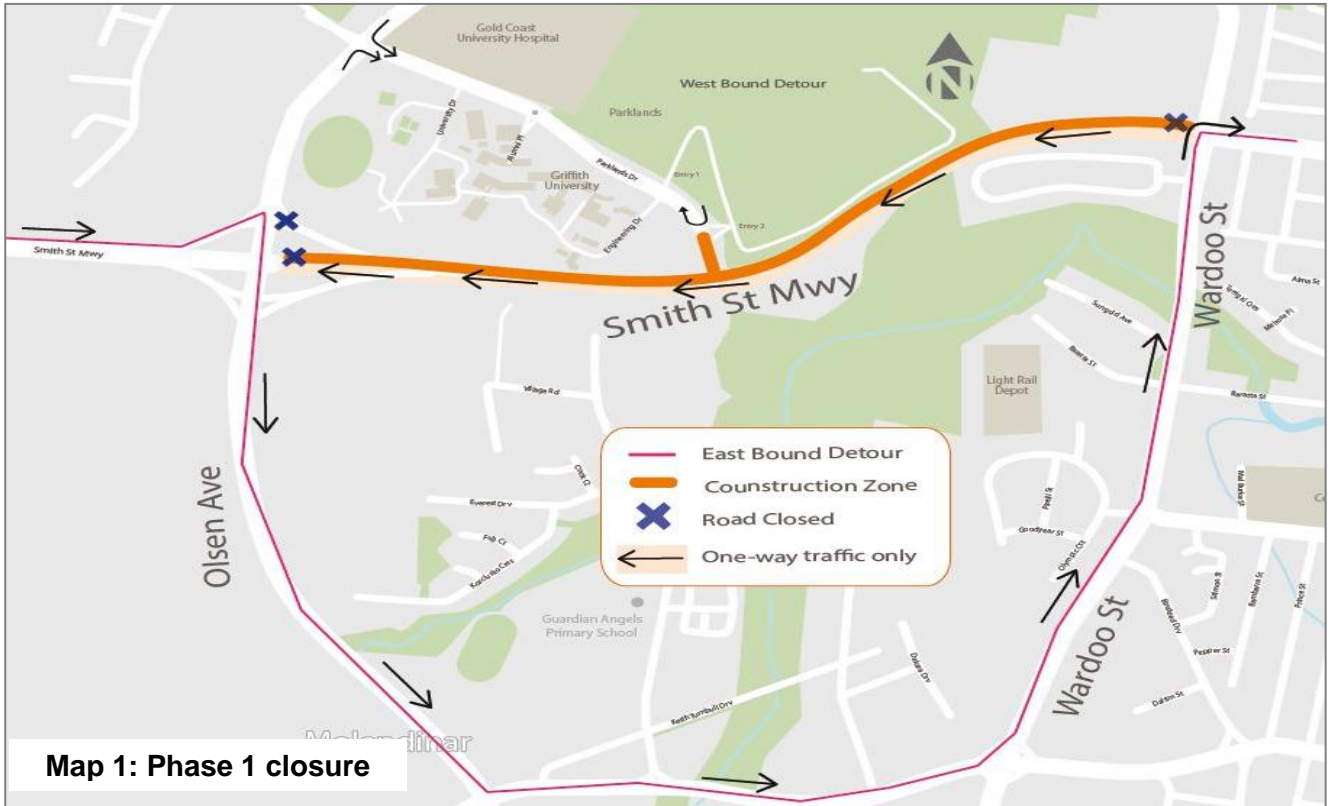

We apologise for any inconvenience and thank you for your patience during construction.

